

①

NEWPORT BRASS

Flawless Beauty. From Faucet to Finish.

INSTALLATION INSTRUCTIONS
INSTRUCCIONES DE INSTALACIÓN

BP TRIM PLATE
PLACA DE MOLDURA BP

SHOWER TRIM
MOLDURAS DE DUCHA

SHOWER AND TUB TRIM
MOLDURAS DE DUCHA Y BAÑERA

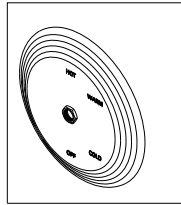

OR

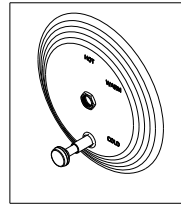

REPRESENTATIVE IMAGE SHOWN IDENTIFY YOUR PRODUCT
IMAGEN REPRESENTATIVA MOSTRADA IDENTIFIQUE SU PRODUCTO

RECOMMEND INSTALLATION BY A PROFESSIONAL PLUMBING CONTRACTOR
RECOMIENDE LA INSTALACIÓN A UN CONTRATISTA DE PLOMERÍA PROFESIONAL

NOTE: THE USE OF PETROLEUM BASE PLUMBERS PUTTY ON OUR PRODUCTS WILL NULLIFY THE WARRANTY.
WE RECOMMEND THE USE OF CLEAR SILICONE SEALING MATERIALS.
NOTA: EL USO DE MASILLA DE PLOMERÍA A BASE DE PETRÓLEO EN NUESTROS PRODUCTOS ANULARÁ LA GARANTÍA.
RECOMENDAMOS EL USO DE MATERIALES DE SELLADO DE SILICONA TRANSPARENTE.

SHOWER TRIM
MOLDURAS DE DUCHA

SHOWER AND TUB TRIM
MOLDURAS DE DUCHA Y BAÑERA

①

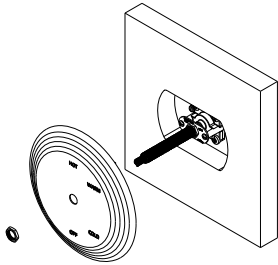

①

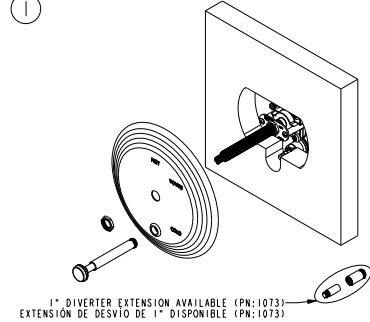

1" DIVERTER EXTENSION AVAILABLE (PN:1073)
EXTENSION DE DESVÍO DE 1" DISPONIBLE (PN:1073)

②

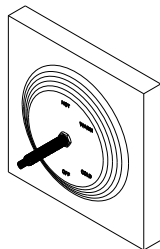

②

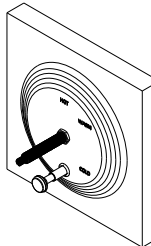

②

NEWPORT BRASS

Flawless Beauty. From Faucet to Finish.

INSTALLATION INSTRUCTIONS
INSTRUCCIONES DE INSTALACIÓN

HANDLES
MANIJAS

SIDE SCREW
TORNILLO LATERAL

TOP SCREW
TORNILLO SUPERIOR

NO SCREW
SIN TORNILLO

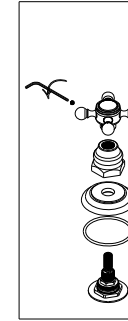

OR

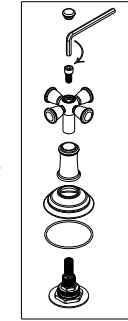

OR

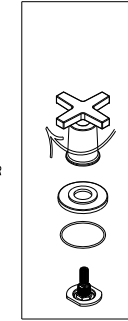

REPRESENTATIVE IMAGE SHOWN IDENTIFY YOUR PRODUCT
IMAGEN REPRESENTATIVA MOSTRADA IDENTIFIQUE SU PRODUCTO

RECOMMEND INSTALLATION BY A PROFESSIONAL PLUMBING CONTRACTOR
RECOMIENDE LA INSTALACIÓN A UN CONTRATISTA DE PLOMERÍA PROFESIONAL

NOTE: THE USE OF PETROLEUM BASE PLUMBERS PUTTY ON OUR PRODUCTS WILL NULLIFY THE WARRANTY.
WE RECOMMEND THE USE OF CLEAR SILICONE SEALING MATERIALS.
NOTA: EL USO DE MASILLA DE PLOMERÍA A BASE DE PETRÓLEO EN NUESTROS PRODUCTOS ANULARÁ LA GARANTÍA.
RECOMENDAMOS EL USO DE MATERIALES DE SELLADO DE SILICONA TRANSPARENTE.

DECK MOUNT
MONTAJE EN CUBIERTA
SEE DECK LAV VALVE INSTALL
VER INSTALACIÓN DE LA VÁLVULA DE LAVADO DE CUBIERTA

SIDE SCREW AND TOP SCREW HANDLE
TORNILLO LATERAL Y MANGO DE TORNILLO SUPERIOR

• ADJUSTABLE HEIGHT
ALTURA AJUSTABLE

SEE DIM A
VER DIM A

NO SCREW HANDLE
SIN MANGO DE TORNILLO

FIXED HEIGHT
ALTURA FIJA

WALL MOUNT
MONTAJE EN PARED
SEE WALL MOUNT VALVE INSTALL
CONSULTE LA INSTALACIÓN DE LA VÁLVULA DE MONTAJE EN PARED

ADJUST TO ALIGN HANDLE
AJUSTAR PARA ALINEAR
EL CONTROLADOR

STEM
TALLO

CUT STEM TO DIM A (-.62")
CORTE EL TALLO PARA
ATENUAR (-.62")

CUT THREADED PIPE TO DIM B
CORTAR TUBO ROSCADO A DIM B

SHOWER PLATE MOUNT
SOPORTE PARA PLATO DE DUCHA
SEE BALANCED PRESSURE VALVE INSTALL
CONSULTE LA INSTALACIÓN DE LA VÁLVULA DE PRESIÓN EQUILIBRADA

CUT STEM TO DIM A
CORTAR PARA ATENUAR UN

CUT THREADED PIPE TO DIM B
CORTAR TUBO ROSCADO A DIM B

COLLECTION NAME	DIMENSION		COLLECTION NAME	DIMENSION	
	A	B		A	B
• ALEXANDRIA	2.37	1.75			
• ALVESTON	2.20	1.62			
• AMISA	2.37	1.80			
• ASTOR	2.20	1.60			
• AYLESBURY	2.00	1.37			
• BEVELLE	2.20	1.70			
• CHESTERFIELD	2.20	1.60			
CLEMENS	1.50	0.75			
DORRANCE	1.37	0.75			
• EAST LINEAR	2.00	1.37			
• EAST SQUARE	2.00	1.37			
• FAIRFIELD	2.20	1.60			
GRIFFEY	1.45	0.62			
ITHACA	1.50	0.50			
• JACOBAN	2.00	1.37			
JOFFREY	1.42	0.50			
KEATON	1.25	0.50			
KIRSI	1.25	0.50			
MALVINA	1.42	0.68			
METRO	1.37	0.50			
• METROPOLE	2.00	1.50			
• MIRO	2.25	1.62			
MUNCY	1.37	0.62			
PARDEES	1.37	0.62			
PAYANI	1.25	0.50			
PRITA	1.25	0.50			
• SEAPORT	2.50	1.87			
SECANT	1.37	0.75			
SKYLAR	1.37	0.75			
• SLATER	2.00	1.37			
• SUTTON	2.00	1.25			
TAFT	1.37	0.75			
TOLMIN	1.37	0.62			
VANDER	1.50	0.62			
• VICTORIA	1.87	1.15			

*SEE CARTON LABEL FOR COLLECTION NAME

3

NEWPORT BRASS

Flawless Beauty. From Faucet to Finish.

INSTALLATION INSTRUCTIONS INSTRUCCIONES DE INSTALACIÓN

SHOWER ARM
BRAZO DE DUCHA

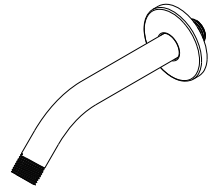

REPRESENTATIVE IMAGE SHOWN
IMAGEN REPRESENTATIVA MOSTRADA

RECOMMEND INSTALLATION BY A PROFESSIONAL PLUMBING CONTRACTOR
RECOMIENDE LA INSTALACIÓN A UN CONTRATISTA DE PLOMERÍA PROFESIONAL

NOTE: THE USE OF PETROLEUM BASE PLUMBERS PUTTY ON OUR PRODUCTS WILL NULLIFY THE WARRANTY.
WE RECOMMEND THE USE OF CLEAR SILICONE SEALING MATERIALS.
NOTA: EL USO DE MASILLA DE PLOMERÍA A BASE DE PETRÓLEO EN NUESTROS PRODUCTOS ANULARÁ LA GARANTÍA.
RECOMENDAMOS EL USO DE MATERIALES DE SELLADO DE SILICONA TRANSPARENTE.

1

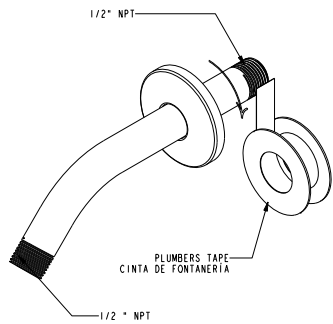

2

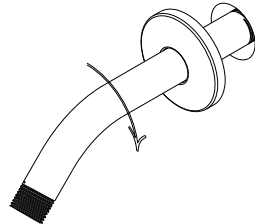

3

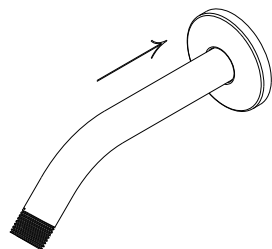

4

NEWPORT BRASS

Flawless Beauty. From Faucet to Finish.

INSTALLATION INSTRUCTIONS INSTRUCCIONES DE INSTALACIÓN

SHOWER HEAD
CABEZAL DE DUCHA

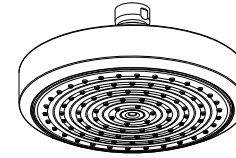

REPRESENTATIVE IMAGE SHOWN
IMAGEN REPRESENTATIVA MOSTRADA

RECOMMEND INSTALLATION BY A PROFESSIONAL PLUMBING CONTRACTOR
RECOMIENDE LA INSTALACIÓN A UN CONTRATISTA DE PLOMERÍA PROFESIONAL

NOTE: THE USE OF PETROLEUM BASE PLUMBERS PUTTY ON OUR PRODUCTS WILL NULLIFY THE WARRANTY.
WE RECOMMEND THE USE OF CLEAR SILICONE SEALING MATERIALS.
NOTA: EL USO DE MASILLA DE PLOMERÍA A BASE DE PETRÓLEO EN NUESTROS PRODUCTOS ANULARÁ LA GARANTÍA.
RECOMENDAMOS EL USO DE MATERIALES DE SELLADO DE SILICONA TRANSPARENTE.

1

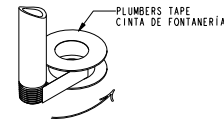

2

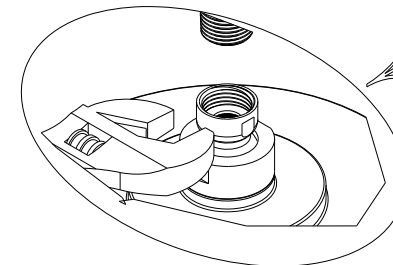
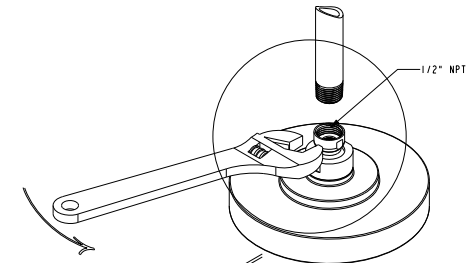

3

5

NEWPORT BRASS

Flawless Beauty. From Faucet to Finish.

INSTALLATION INSTRUCTIONS INSTRUCCIONES DE INSTALACIÓN

SPOUT / SHOWER ARM
CANO / BRAZO DE DUCHA

WALL MOUNT
MONTAJE EN PARED

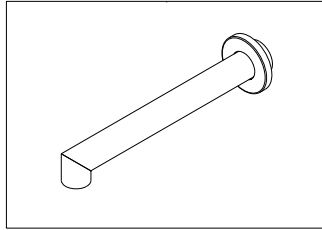

REPRESENTATIVE IMAGE SHOWN
IMAGEN REPRESENTATIVA MOSTRADA

RECOMMEND INSTALLATION BY A PROFESSIONAL PLUMBING CONTRACTOR
RECOMIENDE LA INSTALACIÓN A UN CONTRATISTA DE PLOMERÍA PROFESIONAL

NOTE: THE USE OF PETROLEUM BASE PLUMBERS PUTTY ON OUR PRODUCTS WILL NULLIFY THE WARRANTY.
WE RECOMMEND THE USE OF CLEAR SILICONE SEALING MATERIALS.
NOTA: EL USO DE MASILLA DE PLOMERÍA A BASE DE PETRÓLEO EN NUESTROS PRODUCTOS ANULARÁ LA GARANTÍA.
RECOMENDAMOS EL USO DE MATERIALES DE SELLADO DE SILICONA TRANSPARENTE.

1

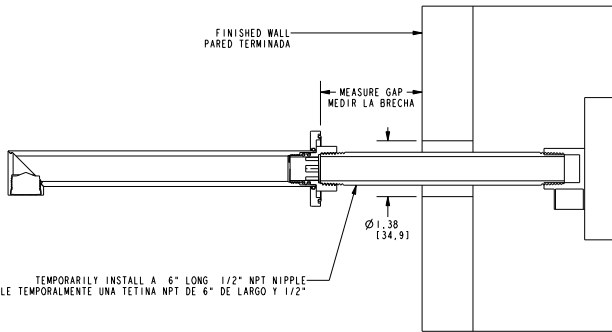

TEMPORARILY INSTALL A 6" LONG 1/2" NPT NIPPLE
INSTALE TEMPORALMENTE UNA TETINA NPT DE 6" DE LARGO Y 1/2"

2

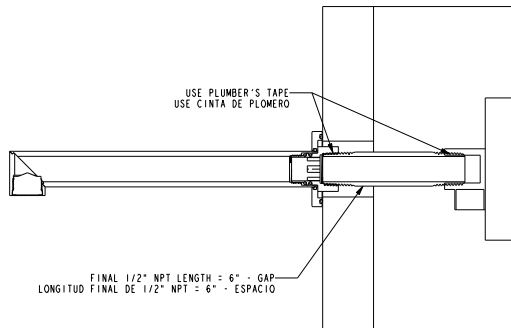

FINAL 1/2" NPT LENGTH = 6" - GAP
LONGITUD FINAL DE 1/2" NPT = 6" - ESPACIO